

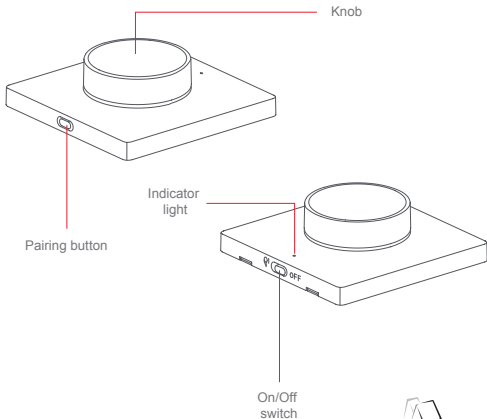

Yeelight Bluetooth Smart Dimmer  
(Wireless)  
Menu

## Product Description



# Installation Guide

## *Yeelight Bluetooth Smart Dimmer*

1. Use a flat-blade screwdriver to pick up the switch cover;

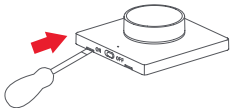

2. Remove the battery insulation tab before use;

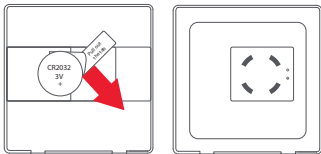

3. Keep the Yeelight Bluetooth Smart Dimmer in the same room as the ceiling light you wish to control. In order to pair it with the light, turn on the light and press and hold for one minute.

At this time, the switch indicator flashes to indicate that it is connecting.

Once the ceiling light blink, this means that the device to be controlled appears to be completed.

If you happen to turn on the Yeelight apps, under the selected light, it will prompt, that is, the connection is successful;

4. Remove the adhesive on the back of the switch and paste the switch in the desired position;

*\*Please make sure the surface that you are going to paste is clean and dry.\**

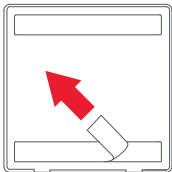

method 2: No need to paste,

\*Purchase a velcro tape or use a blue tack and directly place the switch in the desired position.

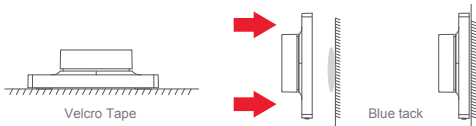

## Dimmer Function

### *Knob*

Press: switch on/ off

Rotate: adjust the brightness of the light

Long press: adjust the color of the atmosphere light

Press + Rotate: adjust the color temperature of the light

Double-tap: Moonlight/Daylight Mode Switch

## Basic Parameters

<b><i>Yeelight Bluetooth Smart Dimmer (Wireless)</i></b>
SKU number: YLKG08YL
Approval/Standard: Q/QDYLK0004-2017
battery model: CR2032
Wireless connections: Bluetooth 4.2 BLE
Operating temperature: -10~+40 °C
Working humidity: 0%-85%RH

## Safety Precautions

1. When the battery is low, please replace the battery in time to avoid affecting your use;
2. Using different types of batteries may damage the product and pose a safety hazard;
3. Children should use a dimmer switch under adult supervision to prevent the button battery from being swallowed by children;
4. When the dimmer switch is not in use for a long time, remove the battery.



## Warranty regulations

1. Unauthorized repair, misuse, collision, neglect, abuse, liquid injection, accident, alteration, or tearing, painting, change, label, anti-counter feiting mark;
2. The validity period of the products has been exceeded;
3. Damage caused by superior force;
4. Does not meet the performance failures listed in the Product Performance Fault Table;
5. Due to human factors, the product and its accessories produce performance failures listed in the Product Performance Fault Table. If used in non-rated voltage, use of non-standard adapter, use in non-specified environment, etc. Product performance failure conditions.



## Names and Content of Hazardous Substances in Product

Component name	Hazardous substance					
	Lead (Pb)	Mercury (Hg)	Cadmium (Cd)	Hexavalent chromium (Cr(VI))	Polybrominated biphenyls (PBB)	Polybrominated diphenyl ethers (PBDE)
Plastic parts	○	○	○	○	○	○
Metal parts	X	○	○	○	○	○
Circuit board	X	○	○	○	○	○

This table is created according to SJ/T 11364 standard.

○: Indicates that the hazardous substance contained in all homogeneous materials of this component is within the limit of the GB/T 26572 standard.

X: Indicates that the hazardous substance contained in a certain homogeneous material of this component exceeds the GB/T 26572 standard.



## Product performance fault table

Product name	Performance failure
Yeelight Bluetooth Smart Dimmer (Wireless)	Knob does not turn
	Indicator does not light up
	Switch cannot be paired due to defect
	Damage to the casing due to structural



## Malaysia & Singapore

\* Service Hours May Applies



Welcome to visit Malaysia & Singapore website [www.yeelight.asia](http://www.yeelight.asia)

Customer Service Email Address: [service@tradegallery.co](mailto:service@tradegallery.co)

Address (Malaysia): The Scott Garden ,58200 Kuala Lumpur

Address(Singapore): 57 Ubi Avenue1, #05-16, Singapore 408936

## China



Welcome to visit official website [www.yeelight.com](http://www.yeelight.com)

Customer Service Email Address: [support@yeelight.com](mailto:support@yeelight.com)

Manufacturer: Qingdao Yeelink Information Technology Co., Ltd.

Address: 10F-B4, Building B, Qingdao International Innovation Park,

No.1 Keyuan Weiyi Road, Laoshan District, Qingdao City, Shandong Province, P.R.China