

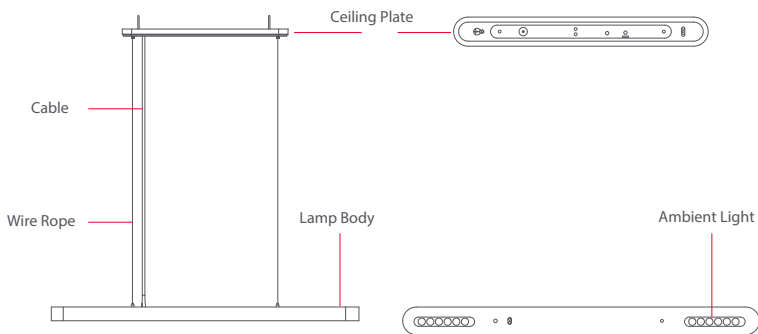

YEELIGHT

Yeelight Crystal Pendant Light User Manual

Product Description



Wall anchor



Self-tapping screw



Wire rope

Installation Instructions

I. Hole boring

1. Take out the light and all the accessories from the package.
2. Confirm installation location.
3. Bore the holes with $\varnothing 8\text{mm}$ electric drill (drilling depth: $L \geq 40\text{mm}$), and mount wall anchors into the holes respectively.

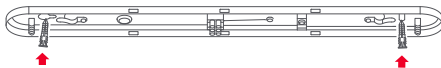

II. Backboard fixation

1. Screw one self-tapping screw into one wall anchor; Do not tighten it, but to reserve 3mm~5mm clearance.
2. Thread the cable out of the silicone sleeve on the back of the ceiling plate and adjust to the proper length.
3. Insert one pre-installed self-tapping screw into the calabash hole, and fix the screw at the narrow side of the hole.

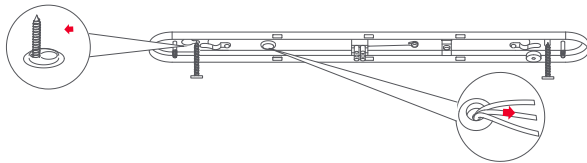

4. Screw another self-tapping screw into the other hole and fix the backboard.



*Please double check the backboard after installation in case of falling down.

III. Wiring

1. Strip the cable for 6mm-8mm.
2. Connect zero line, grounding line, and live line as indicated with the mark N, PE, L respectively;
Then fix the bolts of wiring terminals.

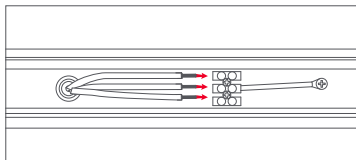
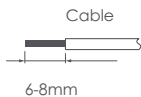

*Caution, risk of electric shock.



*Cut the power before disassembling this product.



*For indoor use only.

IV. Ceiling plate installation

1. Adjust the length of cable according to the suspending height of wire ropes. The extra cable can be stored in the ceiling plate.
2. Fasten the cover of ceiling plate.
3. Screw the twoscrew nuts of wire ropes into the cover of ceiling plate to fix the wire ropes.

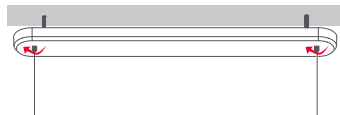
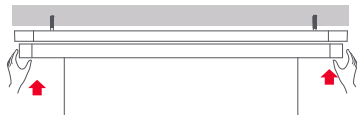

V. Lamp body installation

1. Connect the two wire ropes with lamp body and adjust the length of wire ropes freely.
2. Insert the cable to the splayed ring.
3. Check the suspension level of lamp body. Press the joint to adjust the height of wire ropes to keep the same level.

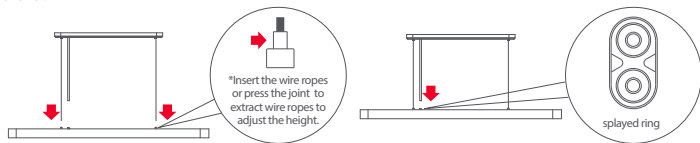

Smart Control

1. Download Yeelight APP in the App store.
2. Turn on the light, open the App, and connect the light with the app according to the instructions .

*Please make sure the Wi-Fi network is available and can get access to the Internet.

*This pendant light works with Yeelight Remote Control.

Product Features



Tunable White Light



Dimmable



Adjustable Height



High CRI



Different Scenes



Smart Voice Control



Remote Access



Update Firmware

Basic Parameters

Model: YLDL01YL

Power factor: 0.9

Operating temperature: -10°C~40°C

Rated input: 220V~240V 50/60Hz 0.16A

Compatible with: Android 4.4&ios 9.0 and above

Name: Yeelight Crystal LED Pendant Light

Color temperature: 2700K-6000K

Operating humidity: 0%-85%RH

Rated power: 33W(280×0.093W+14×0.5W/LED)

Wireless Connectivity: Wi-Fi IEEE802.11 b/g/n 2.4GHz,
bluetooth4.2BLE

How to Reset

Turn on and off the physical switch of pendant light for 5 times (keep on and off for 2s each). The light is reset after breathing for 5s.

*When the pendant light is used in a new network environment, reset the pendant light before connecting with the new network.



Warnings

1. Check the voltage before using this product. Using it under improper voltage may damage the product and cause safety hazards.
2. The light source is non-user replaceable. The light source contained in this luminaire shall only be replaced by the manufacturer or his service agent or a similar qualified person.
3. The light will generate heat during operation. Please keep proper ventilation.
4. The power is not cut off when you turn off the light by Yeelight remote control or Yeelight App. Under this circumstance, do not touch, replace or disassemble the light. Otherwise, it has risks of electric shocks, injuries or even death.
5. The pendant light is not recommended to install in the position where its ambience is within sight of 38cm.



*Cut off the power before installation.

*Please strictly follow the installation procedure in case of fire, electric shock, lampshade falling down, or other accidents.



*Ask electricians for installation or maintenance. Wiring shall comply with IEEE Standard or local rules and regulations.

CE EU Declaration of Conformity

We Qingdao Yeelink Information Technology Co.,Ltd., hereby, declares that this equipment is in compliance with the applicable Directives and European Norms, and amendments.

WEEE Disposal and Recycling

Correct Disposal of this product. This marking indicates that this product should not be disposal with other household wastes throughout the EU.

To prevent possible harm to the environment or human health from uncontrolled waste disposal, recycle it responsibly to promote the sustainable reuse of material resources.

To return your used device, please use the return and collection systems or contact the retailer where the product was purchased. They can take this product for environmental safe recycling.



Malaysia & Singapore

* Service Hours May Applies



Welcome to visit Malaysia & Singapore website www.yeelight.asia

Customer Service Email Address: service@tradegallery.co

Address (Malaysia): The Scott Garden ,58200 Kuala Lumpur

Address(Singapore): 57 Ubi Avenue1, #05-16, Singapore 408936

China



Welcome to visit official website www.yeelight.com

Customer Service Email Address: support@yeelight.com

Manufacturer: Qingdao Yeelink Information Technology Co., Ltd.

Address: 10F-B4, Building B, Qingdao International Innovation Park,

No.1 Keyuan Weiji Road, Laoshan District, Qingdao City, Shandong Province, P.R.China